

## HEPA 14 filtration for exhausted air with activated carbon

**Cod. TA-FV-011-CA, TA-FV-012-CA, TA-FV-013-CA**





This kit can be used for all types of dental suction and can be installed both downstream of the exhaust air outlet (wet suction) and upstream (dry suction). It is easy to install and maintain. The kit also includes the fittings necessary to adapt the filter to 30 and 40 mm diameter tubing, both at the filter inlet and outlet.

Regarding MGF models:

- TA-FV-011-CA , its use is recommended downstream of models Hybrid 1S, Hybrid 1, Hybrid 2 with regard to wet suction and upstream of models Aspir 1, Aspir 2 and Aspir 3 with regard to dry suction.
- TA-FV-012-CA, its use is recommended downstream of Hybrid 5 models with regard to wet suction and downstream or upstream of Aspir 4 models with regard to dry suction.
- TA-FV-013-CA, its use is recommended downstream of the 2x Hybrid 5, 3x Hybrid 5 models with manifolded air exhausts with regard to wet suction.



Dental Chairs: 3

Cod.	 Air capacity	 Size	 net Weight
Kit HEPA 14 - CA - G 1 1/4" TA-FV-011-CA	m <sup>3</sup> /h 8.64	mm 95(C)x98(D)x156(H)x173(Oe)	-
Kit HEPA 14 - CA - G 2 1/2" TA-FV-012-CA	m <sup>3</sup> /h 18	mm 126(C)x118(D)x288(H)x201(Oe)	Kg 3.85
Kit HEPA 14 - CA - G 3" TA-FV-013-CA	m <sup>3</sup> /h 27	mm 162(C)x198(D)x276(H)x201(Oe)	Kg 14

## Diagram

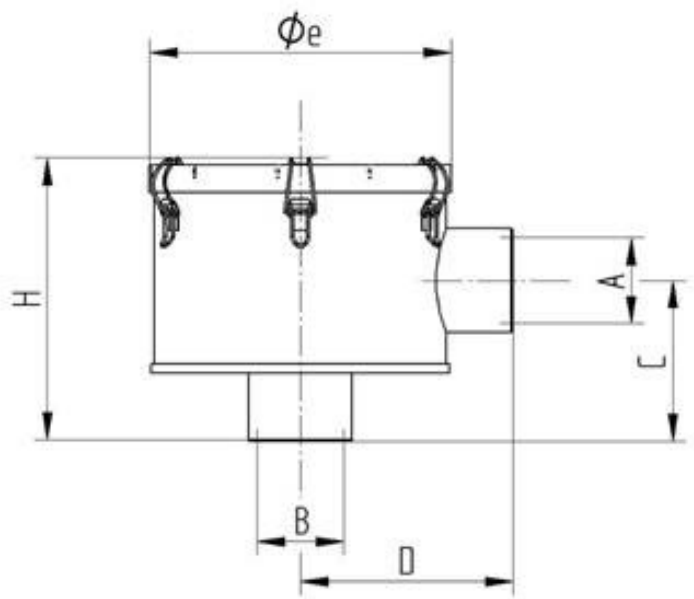

## Maintenance kits

Kit.	Description	Type	Hours
TA-FV-011-CA-C	<b>Activated carbon HEPA H14 filter element for vacuum pump - G 1 1/4 "</b> HEPA H14 filter element with activated carbon for vacuum pump - G 1 1/4 ".	Ordinary	2.000h/2y
TA-FV-012-CA-C	<b>Activated carbon HEPA H14 filter element for vacuum pump - G 2 1/2 "</b> Activated carbon HEPA H14 filter element for vacuum pump - G 2 1/2 ".	Ordinary	2.000h/2y
TA-FV-013-CA-C	<b>Activated carbon HEPA H14 filter element for vacuum pump - G 2 1/2 "</b> Activated carbon HEPA H14 filter element for vacuum pump - G 2 1/2 ".	Ordinary	2.000h/2y

## Images

