

## HEPA 14 exhaust air filtration

**Cod. TA-FV-011, TA-FV-012, TA-FV-013**





Filtration kit with HEPA H14 element for dental extraction. This kit can be used for all types of dental suction and can be installed either downstream of the exhaust air outlet (wet suction) or upstream (dry suction). It is easy to install and maintain. The kit also includes the fittings necessary to adapt the filter to 30 and 40 mm diameter tubing, both at the filter inlet and outlet.

With regard to the MGF:

- TA-FV-011, its use is recommended downstream of models Hybrid 1S, Hybrid 1, Hybrid 2 with regard to wet suction and upstream of models Aspir 1, Aspir 2 and Aspir 3 with regard to dry suction.
- TA-FV-012, its use is recommended downstream of Hybrid 5 models with regard to wet suction and downstream or upstream of Aspir 4 models with regard to dry suction.
- TA-FV-013, its use is recommended downstream of the 2x Hybrid 5 or 3x Hybrid 5 models with manifolded air exhausts. The maximum nominal air flow is 450 m<sup>3</sup>/h.

 Dental Chairs: 3

Cod.	 Air capacity	 Size	 net Weight
Kit filtrazione con elemento HEPA H14 - G 1 1/4" TA-FV-011	m <sup>3</sup> /h 8.64	mm 95(C)x98(D)x156(H)x173(Oe)	Kg 1,7
Kit filtrazione con elemento HEPA H14 - G 2 1/2" TA-FV-012	m <sup>3</sup> /h 18	mm 126(C)x118(D)x288(H)x201(Oe)	Kg 3.85
Kit filtrazione con elemento HEPA H14 - G 3" TA-FV-013	m <sup>3</sup> /h 27	mm 162(C)x198(D)x276(H)x201(Oe)	Kg 14

## Diagram

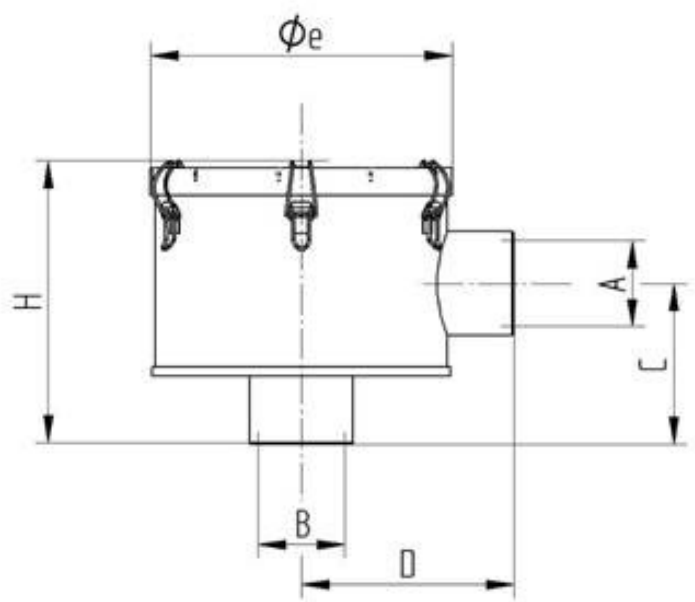

## Maintenance kits

Kit.	Description	Type	Hours
TA-FV-011-C	HEPA H14 filter element for vacuum pump - G 1 1/4 "	Ordinary	2.000h/2y
TA-FV-012-C	HEPA H14 filter element for vacuum pump - G 2 1/2 "	Ordinary	2.000h/2y
TA-FV-013-C	HEPA H14 filter element for vacuum pump - G 3 "	Ordinary	2.000h/2y

## Images

