



## HEPA 14 filtration for exhaust air

**Cod. TA-FV-011**



Filtration kit with HEPA H14 - G 1 1/4 "element for dental suction. This kit can be used for all types of dental suction and can be installed both downstream of the exhaust air discharge (wet suction), and upstream (suction It is easy to install and maintain. The kit also includes the necessary fittings to adapt the filter to pipes with a diameter of 30 and 40 mm, both inlet and outlet from the filter. As regards the MGF models, its use is recommended downstream of the Hybrid 1S, Hybrid 1, Hybrid 2 models as regards the wet suction and upstream of the models of the Aspir 1, Aspir 2 and Aspir 3 models as regards the dry suction. The maximum nominal air flow is 144 m<sup>3</sup> / h.

 Dental Chairs: 3

 Air capacity	 Size	 net Weight
m <sup>3</sup> /h 8.64	mm 95(C)x98(D)x156(H)x173(Oe)	Kg 1,7

### Diagram

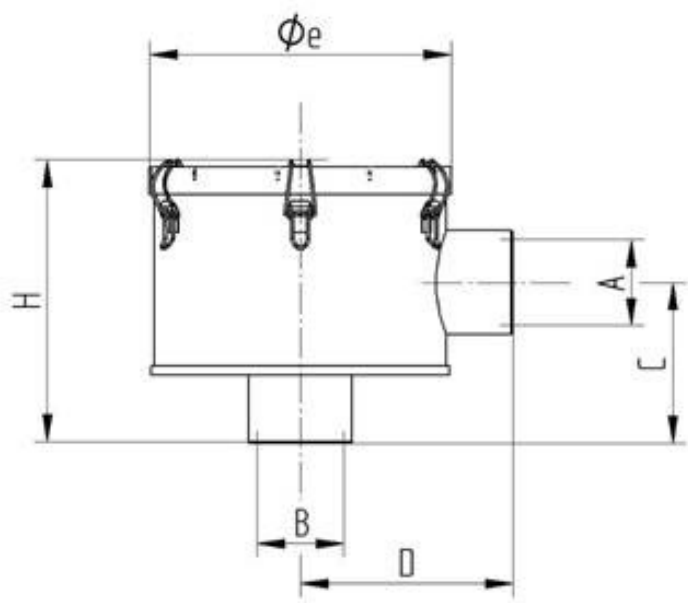

### Maintenance kits

Kit.	Description	Type	Hours
------	-------------	------	-------

TA-FV-011-C	<b>HEPA H14 filter element for vacuum pump - G 1 1/4 "</b> HEPA H14 filter element for vacuum pump - G 1 1/4 ".	Ordinary	2.000h/2y
-------------	--	----------	-----------

## Images

